

DIODE DYNAMICS

PERFORMANCE LIGHTING TECHNOLOGY

HD HALO™

2016-2018 Chevrolet Camaro HD LED Halos



Thank you for your purchase of custom HD LED Halos for your Chevrolet Camaro. With this product, you will be able to add a custom accent inside your headlight that functions as a bright white running light, along with an amber turn signal!



Please note: Headlights must be opened before proceeding with installation. This process can be completed by heating and prying the lens from the housing. We recommend viewing example videos online to understand the process however, professional installation is strongly recommended. Please contact Diode Dynamics if you need assistance locating an installer.

1. Once the headlight is opened, mount the halos to the projector bezel in the headlight using beading wire or epoxy.
2. Next, route the wires to the back of the headlight, sealing any holes that you may create.
3. Connect the halo connectors to the driver and then connect the driver to the pigtail. See diagram below.

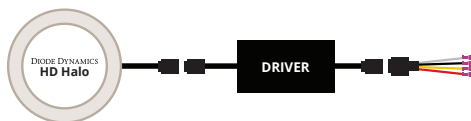

4. Next, tap the bare wires on the pigtail to 12V power and ground. This will dictate when the panels turn on. In the table below, we have listed the suggested wires to tap.

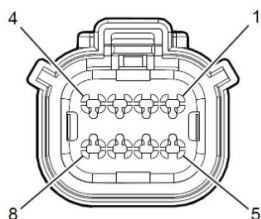

Headlight Connector

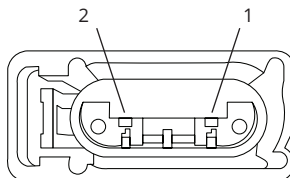

Turn Signal Connector

DD WIRE	PIN	HARNESS LOCATION	DRIVER WIRE	PASSENGER WIRE
RED	PIN 8 - PARKING/DRL	HEADLIGHT	GRAY/BLUE	BLUE/BROWN
WHITE	PIN 1 - LOW BEAM	HEADLIGHT	YELLOW	YELLOW
BLACK	PIN 2 - GROUND	HEADLIGHT	BLACK	BLACK
YELLOW	PIN 1 - TURN SIGNAL	TURN SIGNAL	BLUE/WHITE	GREEN/VIOLET

IMPORTANT: DO NOT plug the LED panel directly into pigtail without the driver. The LEDs must be plugged into driver first to control the power.

5. Mount driver and tuck all wires. **Driver should be mounted outside of headlight for serviceability, in a location away from the engine block to avoid excessive heat buildup.**

6. Test thoroughly and reinstall onto vehicle.

Please contact **Diode Dynamics** should you have any questions about the installation or wiring process, at **314-205-3033** (9a-5p CST) or **contact@diodedynamics.com**.

This installation guide is for the following SKU:

DD2218 Camaro Premium 2016 SB LED Halos

**100% SATISFACTION
GUARANTEE**

**3 YEAR
WARRANTY**

